

# Derby-Shelton Bridge Pedestrian & Bicycle Access Project State Project No. 0126-0174

## Public Information Meeting: January 9, 2019



NAUGATUCK VALLEY  
COUNCIL of GOVERNMENTS

**AECOM**

ANSONIA • BEACON FALLS • BETHLEHEM • BRISTOL • CHESHIRE • DERBY • MIDDLEBURY • NAUGATUCK • OXFORD • PLYMOUTH  
PROSPECT • SEYMOUR • SHELTON • SOUTHBURY • THOMASTON • WATERBURY • WATERTOWN • WOLCOTT • WOODBURY

# Welcome & Introductions

- ▶ Mark C. Nielsen, Assistant Director  
Naugatuck Valley Council of Governments (NVCOG)
    - Project Overview
    - Project Context: Related Derby–Shelton Efforts
  
  - ▶ Design Team:
    - Project Administration: [NVCOG](#)
    - Consultant Engineer: [AECOM](#)
    - Project Oversight/Design Review: [CT DOT](#) / [BL Companies](#)
- 

# Follow-up from April 18, 2018 PIM

- ▶ **Purpose & Need of the Project:**
  - Renovate deteriorated pavement & bridge deck
  - Reconfigure to provide bicycle/pedestrian plaza
  - Develop gateway between downtown Derby & downtown Shelton
  - Maintain historical integrity – approval from SHPO
  - Connect Derby Greenway & Shelton RiverWalk
- ▶ **Presented Preliminary Design Plans:**
  - Reconfigure bridge deck: rehabilitate pavement & narrow travel lanes
  - Maintain 2 travel lanes
  - Install 10-foot, bi-directional cycle-track
  - Create 11-foot to 13-foot pedestrian area
  - Replace concrete parapets & add decorative lights & railing



# Follow-up from April 18, 2018 PIM

- ▶ **Concerns expressed by attendees:**
  - Congestion on the bridge during evening – concern the project will worsen
  - Need for a third lane on the bridge
  - How the new access road from the SpongX redevelopment will be accommodated?
  - Bump-out for cycle-track/pedestrian plaza & alignment of the reconfigured lanes with the lanes on the “viaduct” bridge
- ▶ **Positive comments expressed by attendees:**
  - Great opportunity to connect two communities
  - Nice plan; it considers people, not just cars
  - Design looks great

# Since the last meeting...

- ▶ Prepared Report of Meeting & Response to Comments:
  - Posted to NVCOG website ([www.nvcogct.org](http://www.nvcogct.org))
- ▶ Wanted to retain concept for bike/pedestrian plaza & address public concerns
- ▶ Design Team considered several options:
  - Maintaining the PD plans as presented – no change
  - Installing a longer EB storage lane
  - Eliminating the cycle track / installing bike lanes
  - Narrowing the pedestrian plaza
  - Tapering the transition between the “viaduct” bridge & Derby–Shelton Bridge
  - Adding a second EB travel lane

# Revised concept...

- ▶ 5-foot sidewalk on north side – no change
- ▶ 2-foot EB & WB shoulders – reduced from 4-foot shoulder width
- ▶ 3, 11-foot travel lanes – 2<sup>nd</sup> EB lane added
- ▶ 4-foot buffer between the road and pedestrian/bicycle plaza – install planters to add separation
- ▶ ≈ 17-foot bicycle/pedestrian plaza – narrowed by ≈ 5 feet
  - 10-foot cycle-track
  - 7-foot pedestrian space
- ▶ Textured pavement for pedestrian space to differentiate from cycle-track (smooth surface) – physical barrier eliminated



# Proposed Plan (Revised)

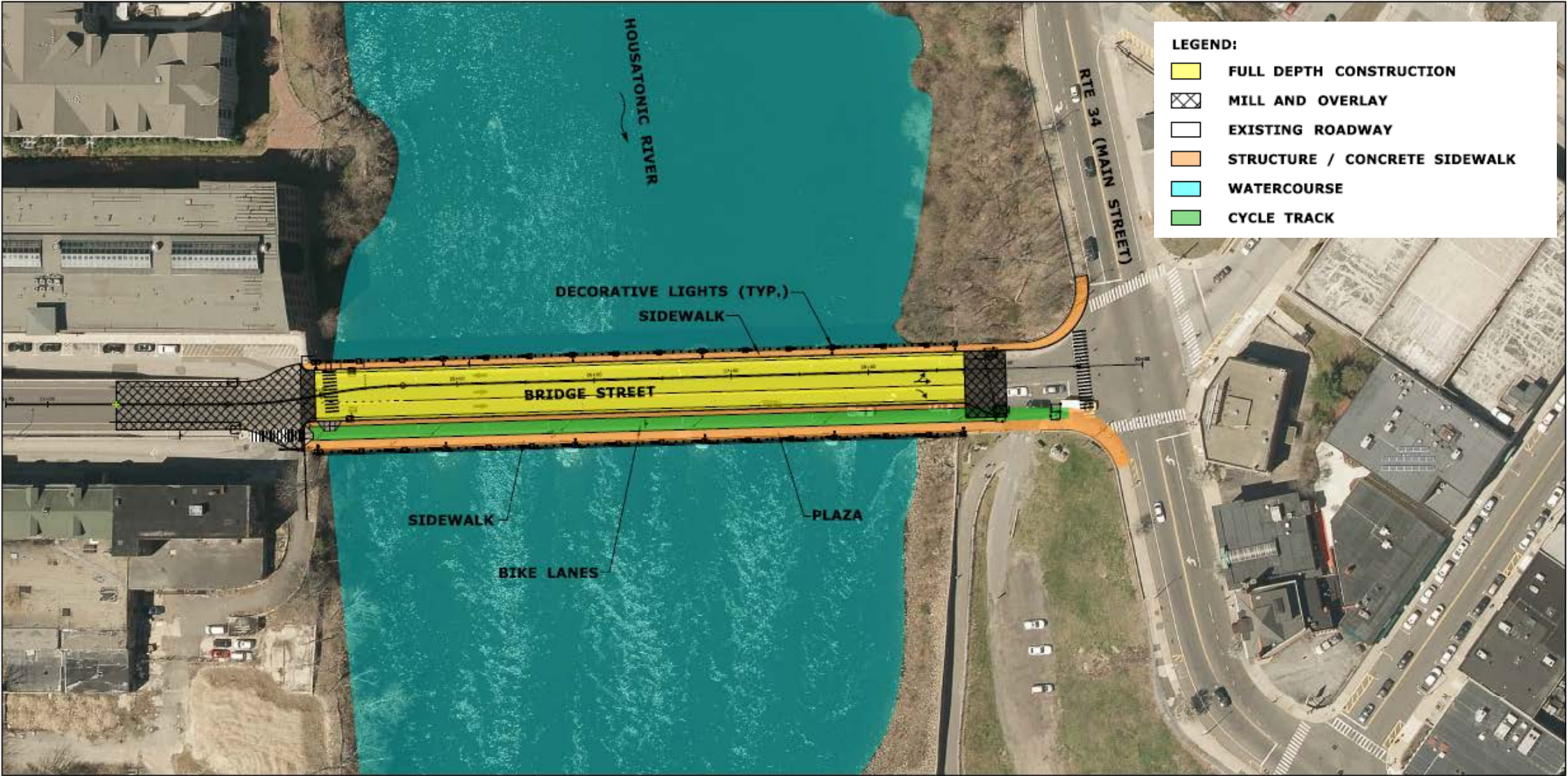

# Preliminary Road Alignment (Revised)

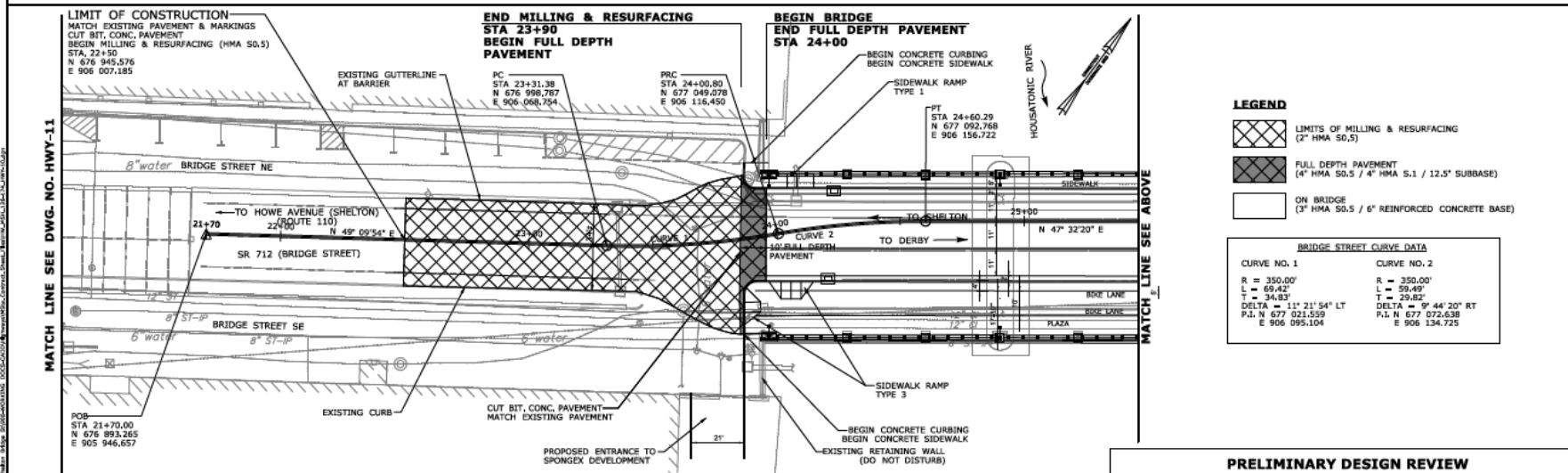
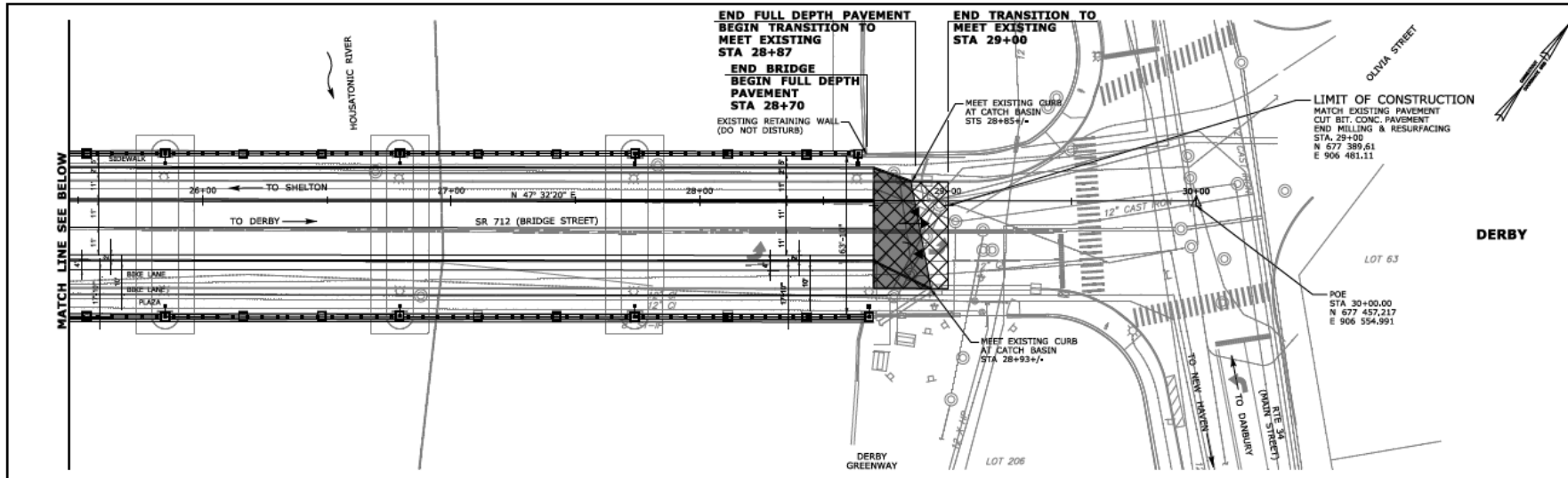

**LEGEND**

- [Cross-hatched box] LIMITS OF MILLING & RESURFACING (2" HMA 50,5)
- [Diagonal-hatched box] FULL DEPTH PAVEMENT (4" HMA 50,5 / 4" HMA 5,1 / 12.5" SUBBASE)
- [White box] ON BRIDGE (3" HMA 50,5 / 6" REINFORCED CONCRETE BASE)

**BRIDGE STREET CURVE DATA**

CURVE NO. 1	CURVE NO. 2
R = 350.00'	R = 350.00'
T = 69.42'	T = 58.49'
L = 34.83'	L = 29.82'
DELTA = 11° 21' 54" LT	DELTA = 9° 44' 20" RT
P.I. = N 677 023.559 E 906 095.104	P.I. = N 677 072.638 E 906 134.725

<p>THE INFORMATION CONTAINED HEREIN IS THE PROPERTY OF THE NAUGATUCK VALLEY COUNCIL OF GOVERNMENTS. IT IS TO BE USED ONLY FOR THE PROJECT AND SITE SPECIFICALLY IDENTIFIED HEREIN. ANY REUSE OR MODIFICATION OF THIS INFORMATION WITHOUT THE WRITTEN PERMISSION OF THE NAUGATUCK VALLEY COUNCIL OF GOVERNMENTS IS STRICTLY PROHIBITED.</p>			<p>PROJECT TITLE: <b>DERBY-SHELTON BRIDGE (NO. 01659) PEDESTRIAN AND BICYCLIST ACCESS IMPROVEMENTS</b></p>		<p>TOWN: <b>SHELTON AND DERBY</b></p>		<p>PROJECT NO. <b>126-174</b></p>	
<p>DATE: 03/20/2018</p>			<p>DRAWING TITLE: <b>ALIGNMENT &amp; ROADWAY PLAN</b></p>		<p>DESIGNER: <b>HWY-10</b></p>		<p>SHEET NO. <b>03.11</b></p>	



# Proposed Typical Section (Revised)

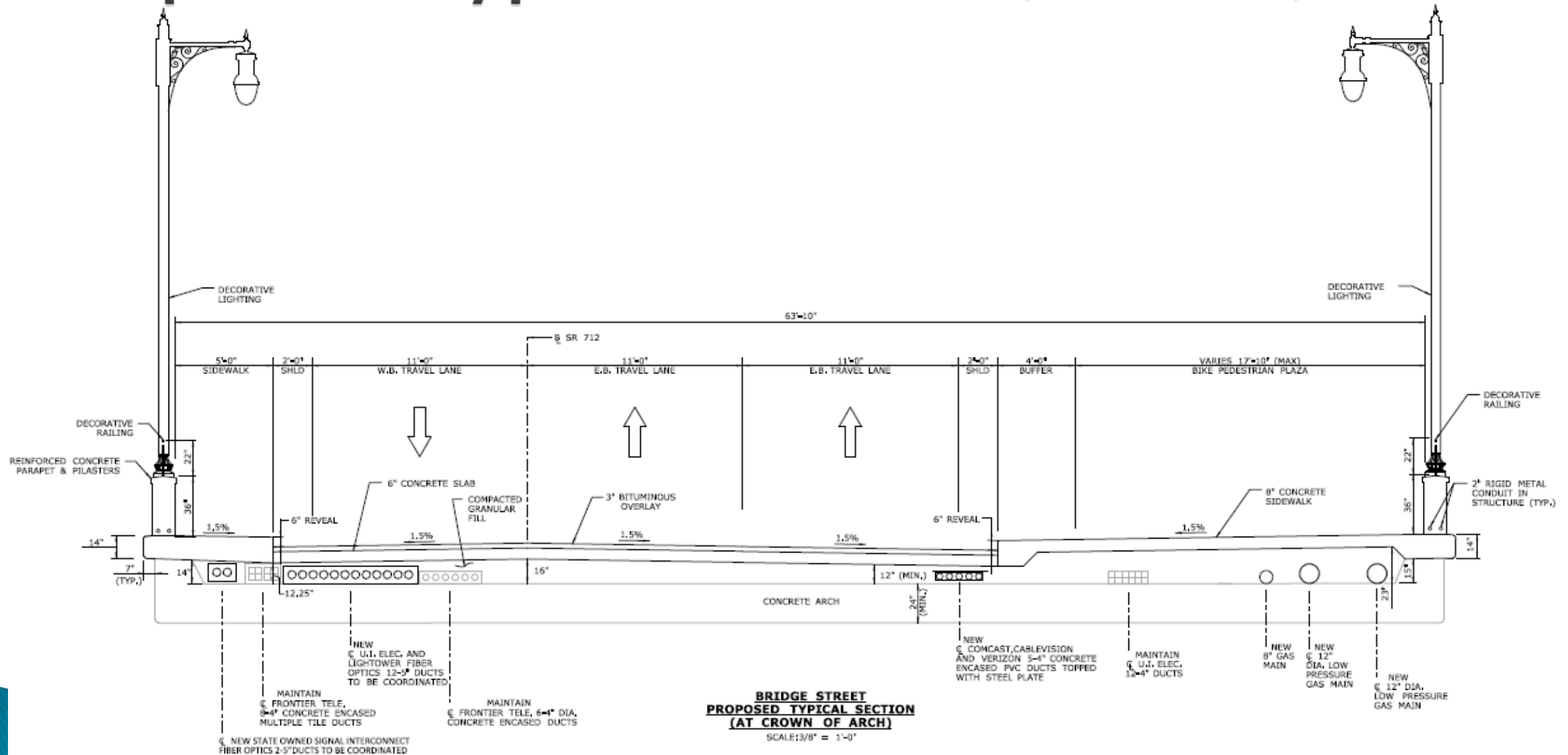

# Proposed Schematic (Revised)

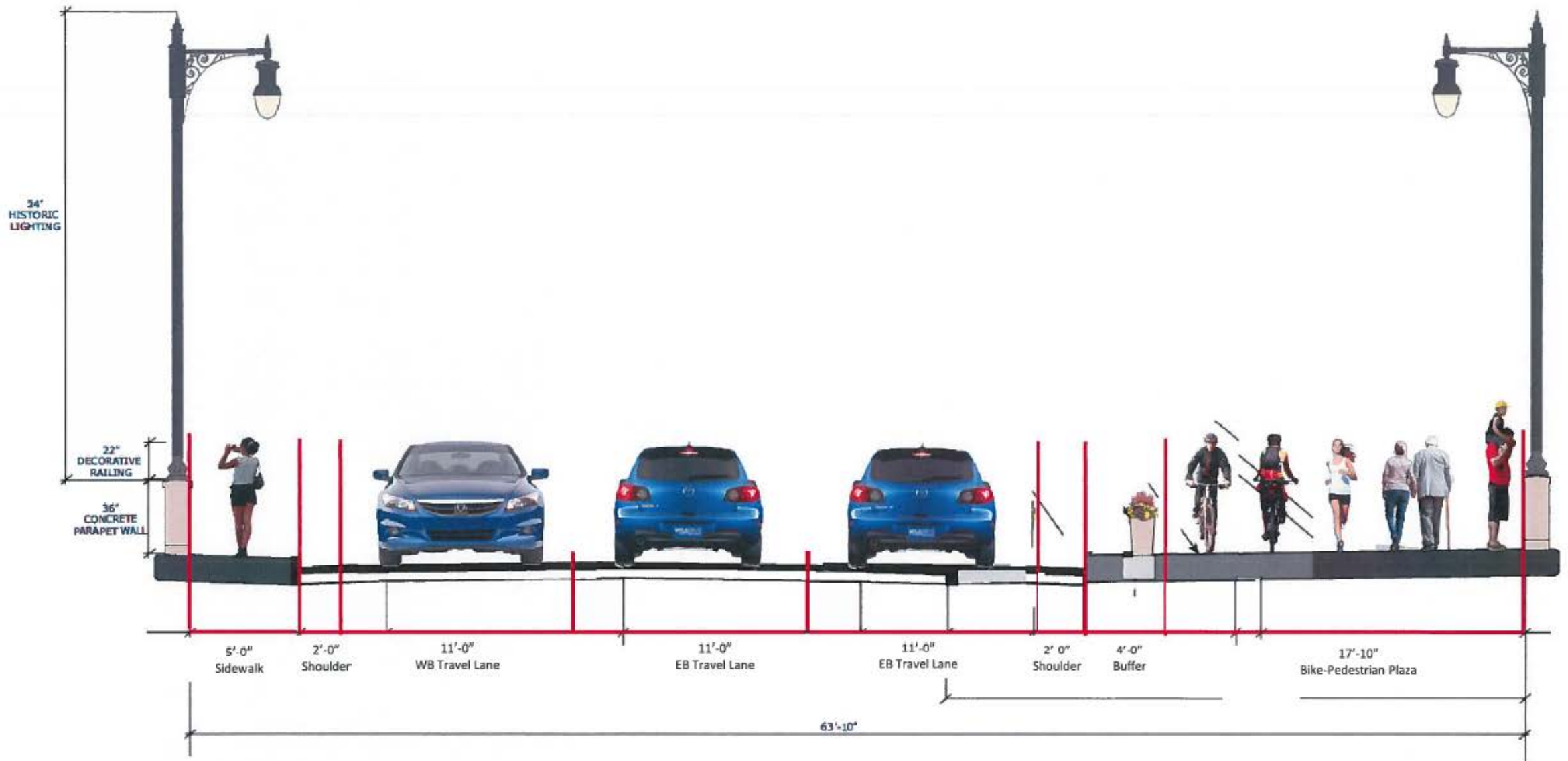

# Proposed Perspective (Revised)





# Proposed Elevation (No Change)



# Next Steps...

- ▶ Work with City of Shelton & CTDOT on extending project to Canal Street
- ▶ Coordinate design with new roadway through SpongX parcel
- ▶ Initiate Final Design phase
- ▶ Revised Schedule:
  - Initiate Final Design: **November 2018**
  - Design Completion Date : **May 2020**
  - Begin Construction: **October 2020**
  - End Construction: **December 2021**

# Questions & Input...

- ▶ NVCOG website:  
[www.nvcogct.org/content/derby-shelton-bridge-enhancements](http://www.nvcogct.org/content/derby-shelton-bridge-enhancements)
- ▶ Mark C. Nielsen – Assistant Director  
Naugatuck Valley COG  
Ph: 203.489.3069  
Email: [mnielsen@nvcogct.org](mailto:mnielsen@nvcogct.org)
- ▶ Andre St. Germain, PE – Project Engineer  
AECOM  
Ph: 860.263.5837  
Email: [andre.st.germain@aecom.com](mailto:andre.st.germain@aecom.com)





# City Center Connectivity





# Project Area

